

# GRIP PRODUCTS

## GRIP-R

### Repair Coupling

The Grip-R coupling is ideal for all situations where you need to make a permanent repair under pressure.

Simply open up the coupling, wrap it around the pipe and fasten- you have repaired the pipeline such as pipe joints, cracks etc in minutes and avoided the need for costly downtime.

Suitable for pipes O.D  $\phi 26.9$ - $\phi 168.3$ mm



### Outside view

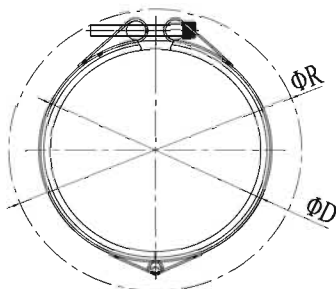
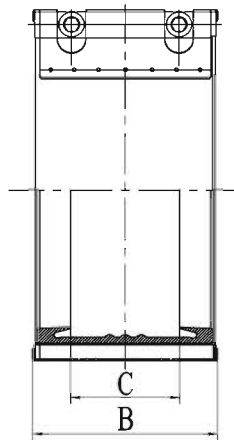

Material	V1	V2	V3	V4	V5	V6
<b>Components</b>						
Casing	AISI 304	AISI 316L	AISI 316TI	AISI 316L	AISI 316TI	
Bolts	AISI 304	AISI 316L	AISI 316L	AISI 304	AISI 304	
Bars	AISI 304	AISI 316L	AISI 316L	AISI 304	AISI 304	
Anchoring ring						
Strip insert (optional)	AISI 301	AISI 301	AISI 301	AISI 301	AISI 301	



**Note:**

1: Strip insert can be customized in AISI 316L/316TI

2: Please consult the BJ-GRIP technical department or its Agents when what you need is beyond the range of normal specification

# GRIP PRODUCTS

## GRIP-R

Pipe outside diameter		Clamping range	Working pressure		Product O.D.	Width	Distance between sealing slips	Setting gap between pipe ends		Torque rate	Bolt
O.D.	Min-Max			$\Phi$ D	B	C	without strip insert	with strip insert (Max)	(Nm)	M	
(mm)	(in.)	(mm)	(bar)	(mm)	(mm)	(mm)	(mm)	Max (mm)			
26.9	1.059	26-28	25	40	38	57	30	5-8	10	8	
30	1.181	29-31	25	40	42	57	30	5-8	10	8	M6×2
33.7	1.327	32-35	25	40	45	57	30	5-8	10	8	
38	1.496	37-39	25	40	50.3	61	26	5-8	10	10	
42.4	1.669	41-43	25	40	54.7	61	26	5-8	10	10	M8×1
44.5	1.752	44-46	25	40	56.8	61	26	5-8	10	10	
48.3	1.902	47-50	25	40	64.2	61	26	5-8	10	10	
54	2.126	52-56	20	35	70	76	37	5-10	15	10	
57	2.244	55-59	20	35	73	76	37	5-10	15	10	M8×2
60.3	2.374	59-62	20	35	76.2	76	37	5-10	15	10	
66.6	2.622	64-68	20	40	85.5	95	37	5-10	25	20	
70	2.756	68-71	20	40	89	95	41	5-10	25	20	
73	2.874	71-75	20	40	92	95	41	5-10	25	20	
76.1	2.996	74-78	20	40	95.2	95	41	5-10	25	20	
79.5	3.130	78-80	20	40	98.5	95	41	5-10	25	20	
84	3.307	82-86	20	40	103	95	41	5-10	25	20	
88.9	3.500	87-91	20	40	108	95	41	5-10	25	20	M8×2
100.6	3.961	99-103	18	35	120	95	41	5-10	25	20	
101.6	4.000	100-104	18	35	120.7	95	41	5-10	25	20	
104	4.094	102-106	18	35	123	95	41	5-10	25	20	
104.8	4.126	103-107	18	35	124	95	41	5-10	25	20	
108	4.252	106-110	18	35	127	95	41	5-10	25	20	
114.3	4.500	112-116	18	35	133.4	95	54	5-10	25	20	
127	5.000	125-129	18	40	148	110	54	5-10	35	25	
129	5.079	127-131	18	40	150	110	54	5-10	35	25	
130.2	5.126	128-132	18	40	151.3	110	54	5-10	35	25	
133	5.236	131-135	18	40	154	110	54	5-10	35	25	
139.7	5.500	138-142	18	40	160.8	110	54	5-10	35	25	M12×2
141.3	5.563	139-143	18	35	162.4	110	54	5-10	35	25	
154	6.063	152-156	18	35	173.4	110	54	5-10	35	25	
159	6.260	157-161	18	35	180	110	54	5-10	35	25	
168.3	6.626	166-171	18	35	186	110	54	5-10	35	25	

**Note:**

Above table shows most common sizes, couplings can be customized for special outside diameters. Please contact us for further details.

 Working pressure for marine applications. Minimum burst is 4 times working pressure. Figures are based on typical values for standard wall carbon steel pipe.

 Working pressure for industrial and land-based applications. Minimum burst is 1.5 times working pressure.

Figures are based on typical values for standard wall carbon steel pipe.

Typing errors may occur, technical details are subject to change as improvements of products.